

沙田 302 管理有限公司

S.T. 302 Management Limited

地址：新界沙田安景街 19 至 21 號地下

電話：2646 1859 傳真：2637 6131

本公司檔號：ST302/NTT/024/17/CH

致：碧濤花園第一期各業戶

通 告

金蘭閣外牆混凝土剝落事宜

本處職員於本年一月二十三日發現金蘭閣近十三樓 D 室外牆有混凝土剝落現象，本處已即時圍封平台有關位置及安排認可承辦商進行緊急維修工程。

管理處將密切監察上述外牆情況及作出跟進，敬請各業戶盡量遠離有關範圍以免發生意外。

敬希垂注，多謝合作！

碧濤花園第一期管理處

2017 年 1 月 23 日

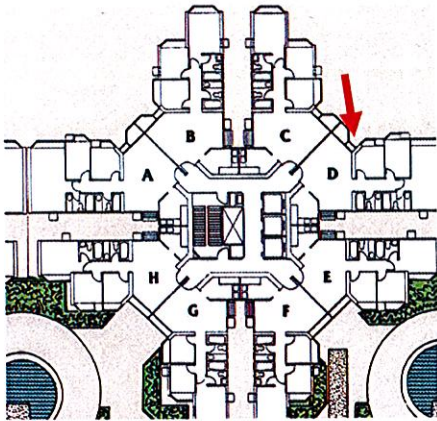

Date : 23 January, 2017

To : All Residents of Pictorial Garden Phase I

NOTICE

Concrete Spalling at External Wall of Capilano Court

It had come to our attention that a major concrete spalling is found on Flat D, 13/F external wall at Capilano Court on 23 January 2017. For safety, there were not only fenced off portion area of podium under the scope of the aforesaid location, but also the emergency repair would be carried out by registered contractor.

All owners/residents are kindly advised to keep away from the aforesaid location so as to minimize the possibility of accident. Beside, Management Office would closely monitor the external wall condition.

Thank you for your co-operation.



Management Office of Pictorial Garden Phase I